

CAVIUS

RECESS KIT BASE FOR 2203 CAVMP

**PLEASE READ THE USER GUIDE
CAREFULLY BEFORE INSTALLATION
AND RETAIN FOR FUTURE USE.**



Product Code: 2901 RK

Designed to be installed with the 2203 CAVMP
– CAVIUS Wireless Family Mains Powered
Photoelectric Smoke Alarm only.

SMOKE ALARM TECHNICAL INFORMATION:

The smoke alarm is powered by mains power (110-230V AC), with a lithium CR2 back-up battery.

It can be Radio Frequency (RF) interconnected with other 2203 CAVMP alarms and CAVIUS™ Wireless Family battery-operated alarms. The maximum number of alarms that can be interconnected within a house group are 32.

Our Mains Powered alarms can only interconnect via radio frequency technology. There are no terminals to interconnect together with cable.

Please note: These must be alarms from the CAVIUS™ Wireless Family range.

The distance between interconnected alarms depends on the house layout and they should always be tested after installation. It is not advised to install alarms with a separation of more than 10m.

WIRELESS.))

ALARM FAMILY

Diameter: 97mm. Height: 52mm (without mounting base), 52mm (with standard mounting base), 22mm (with recess kit base).

Radio Frequency: 926.365 MHz

Complies to standards: AS3786:2014

Do not paint the alarm.

Disposal: For battery and product, please dispose properly at the end of life. This is electronic waste which should be recycled at an authorised e-waste facility.

WARNING: Please remove dust cover after installation. Smoke will not be able to reach the chamber while the dust cover is in place.

All Rights Reserved: CAVIUS™ Aps assumes no responsibility for any errors, which may appear in this manual. Furthermore, CAVIUS™ Aps reserves the right to alter the hardware, software, and/or specifications detailed herein at any time without notice, and CAVIUS™ Aps does not make any commitment to update the information contained herein. All the trademarks listed herein are owned by their respective owners.

INSTALLING THE ALARM WITH THE RECESS KIT BASE:

Using the hole saw drill (102mm) cut into the ceiling where recess kit and alarm will be located.

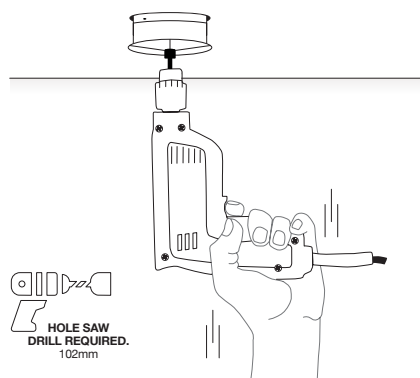

Punch out rectangle grommet and feed through the cable.

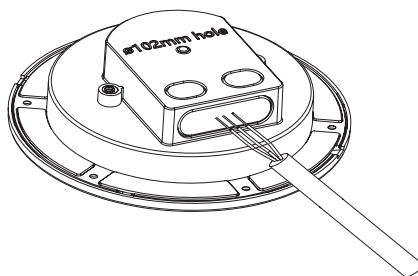

Connect the feed wire into the power supply unit and screw after termination.

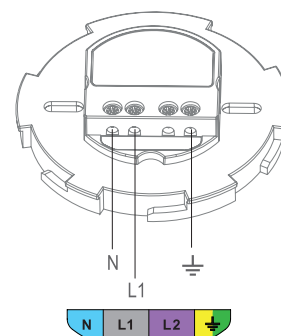

Screw recess kit base onto the ceiling. Then screw power supply unit inside the recess kit base.

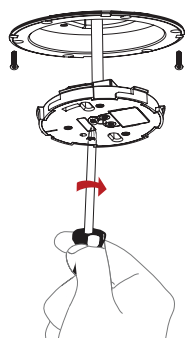

Attach the alarm by twisting clockwise into the power supply unit until it clicks. If the battery is either missing or inserted incorrectly, the smoke alarm will not be able to click into the power supply unit.

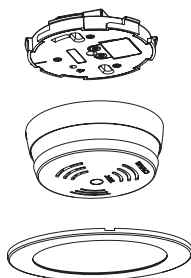

Click on the cover ring.



Manufactured by:

CAVIUS Aps

Julsøvej 16 - DK8600 Silkeborg
www.cavius.com - info@cavius.com
Manufactured in P.R.C.

Distributor information:

New Zealand:

On Point Distribution Partners Ltd.

58a Poplar Lane, Papamoa, Bay of Plenty 3187,
New Zealand
P.O. Box 11241, Palm Beach Plaza, Papamoa,
Bay of Plenty 3151, New Zealand.

www.cavius.co.nz | PH: 07 573 8670

Australia:

CAVIUS Australia

GPO Box 303, Brisbane, QLD 4001.

www.cavius.com.au | 07 3556 1441

WARRANTY:

CAVIUS provides a 10-year warranty against defect in faulty material and workmanship from the date of purchase, on all devices.

The warranty applies to reasonable and normal conditions of use only. It does not include damage as a result of misuse, incorrect installation, accidental damage, neglect, unauthorised deconstruction or dismantling and any airborne or other contamination however this may have occurred.

If this product has an acknowledged defect it must be returned to the national CAVIUS Distributor at the purchasers cost with the proof of purchase.

If the product has become defective within the 10-year warranty, CAVIUS APS, Denmark will repair or replace the unit without charge and send back to the purchaser, via the national Distributor at the Distributors cost. The guarantee excludes labour costs, freight costs, service costs and any incidental and consequential damages.

Do not attempt to repair or service this product as this will invalidate the warranty.

Under some unusual circumstances the presence of high levels of radio spectrum pollution may result in the batteries within the CAVIUS device not lasting as indicated in the product sheet. Radio spectrum pollution comprises transmissions inside the band allocated for alarm devices such as the CAVIUS devices. Such transmissions may activate the receiver inside the devices for a longer time than is normal in standby.

This is not a specific problem for CAVIUS devices but for all similar radio linked technology powered by batteries. The limited warranty will not cover the battery life period indicated in the product sheet in these situations.

This warranty is in lieu of any other warranty either expressed or implied.

You can register your CAVIUS devices on our website.

